

ALL WASTEWATER INSTALLATIONS TO COMPLY WITH IRISH WATER CONNECTION AND DEVELOPER SERVICES

WASTE WATER INFRASTRUCTURE STANDARD DETAILS

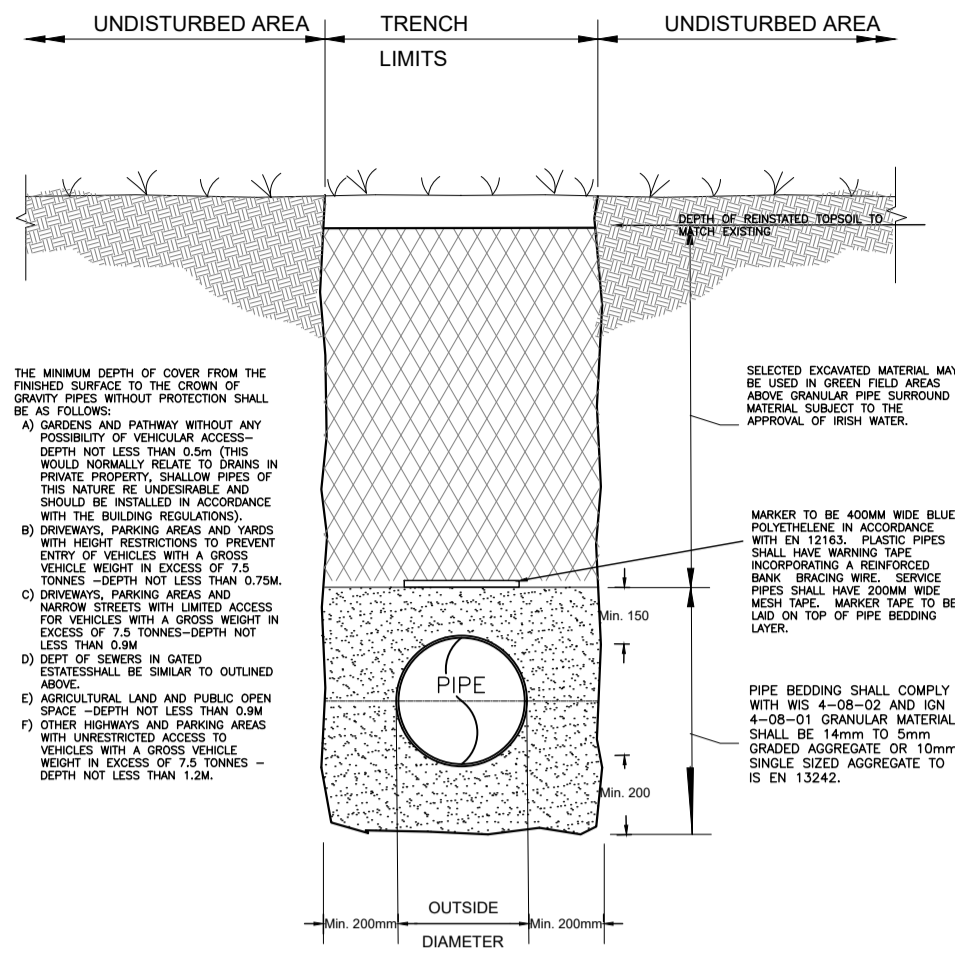

BEDDING DETAILS ACROSS OPEN SPACE

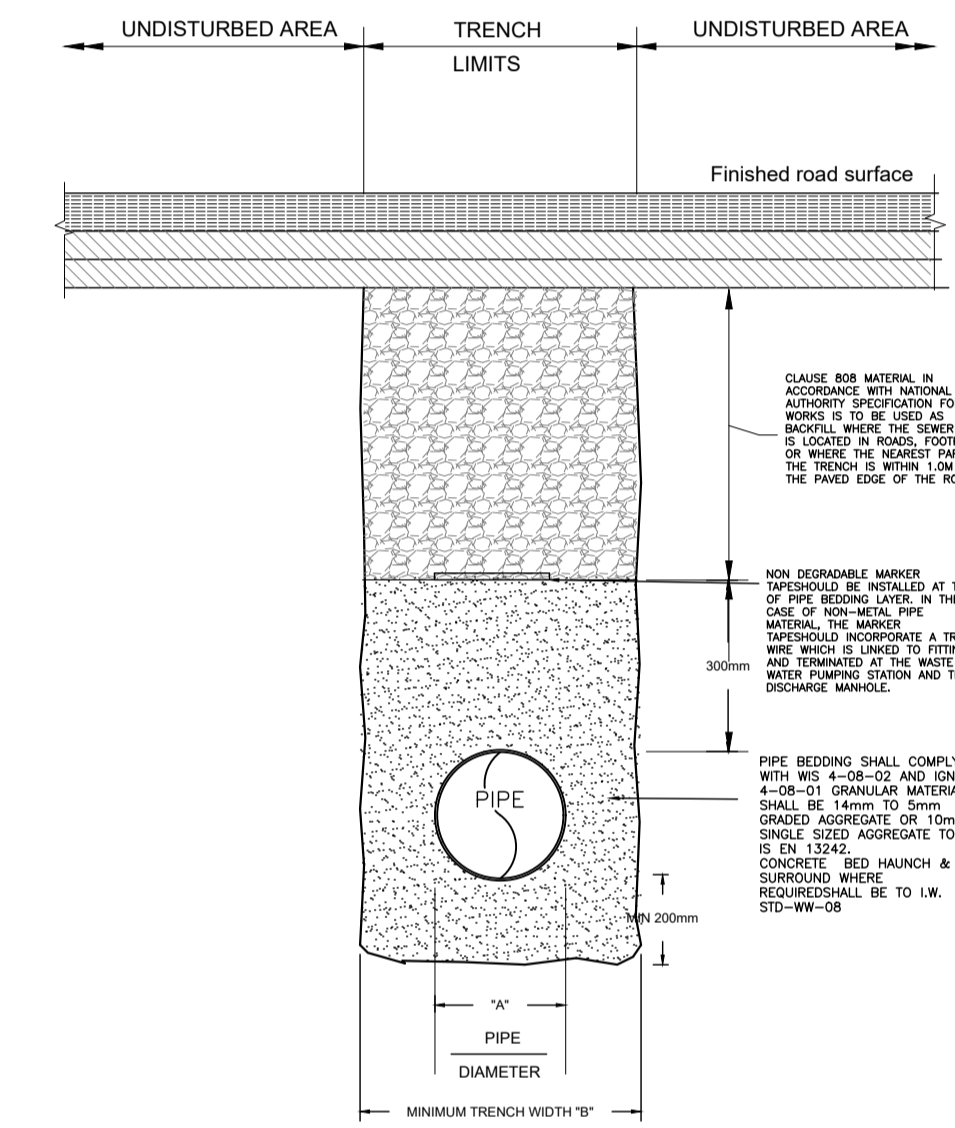

NOTES:  
1. IF TRENCH BOTTOM CONTAINS ROCK, THEN A MINIMUM OF A 500mm PIPE BEDDING SHALL BE USED.

PIPE DIAMETER "A" (mm)	TRENCH WIDTH "B" (mm)
100	500
150	600
225	675
300	750

BEDDING DETAILS ACROSS ROADS & FOOTPATHS

TYPICAL TRENCH DETAILS (scale 1:20)

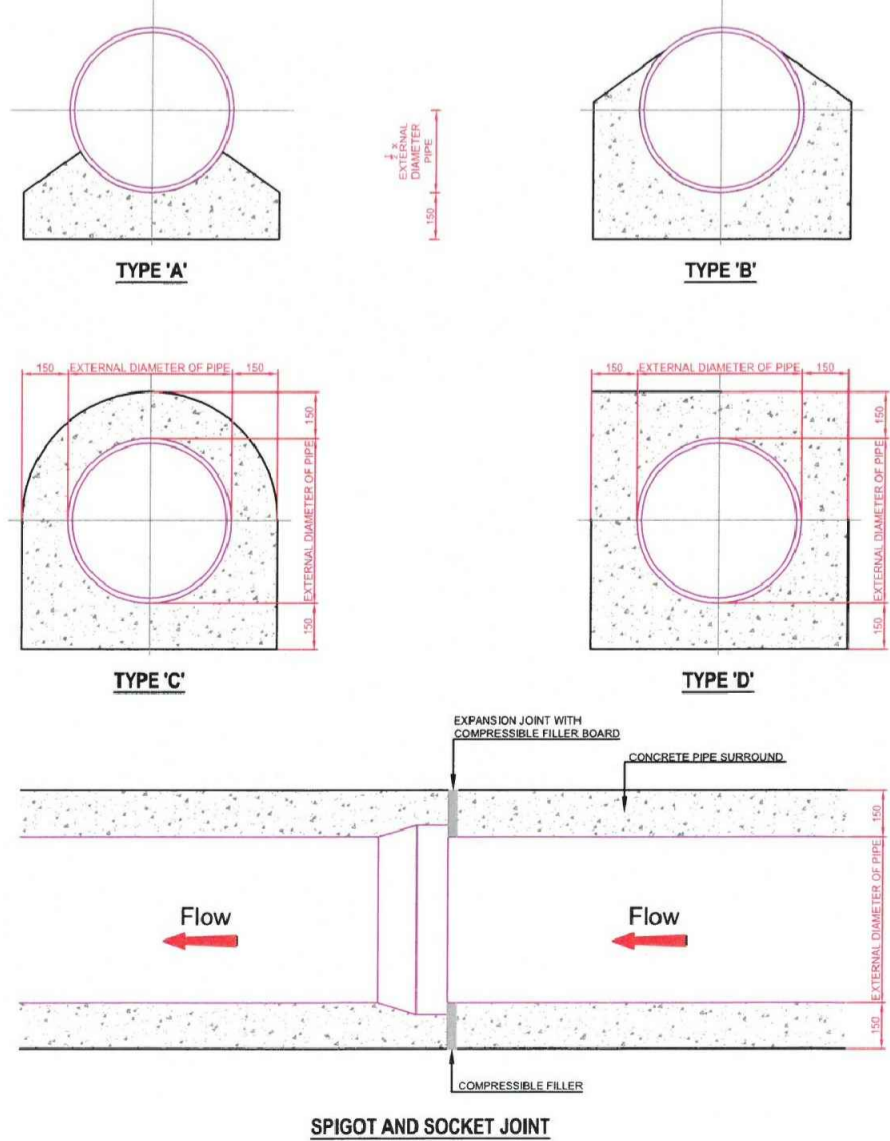

CONCRETE HAUNCH DETAILS (scale 1:25)

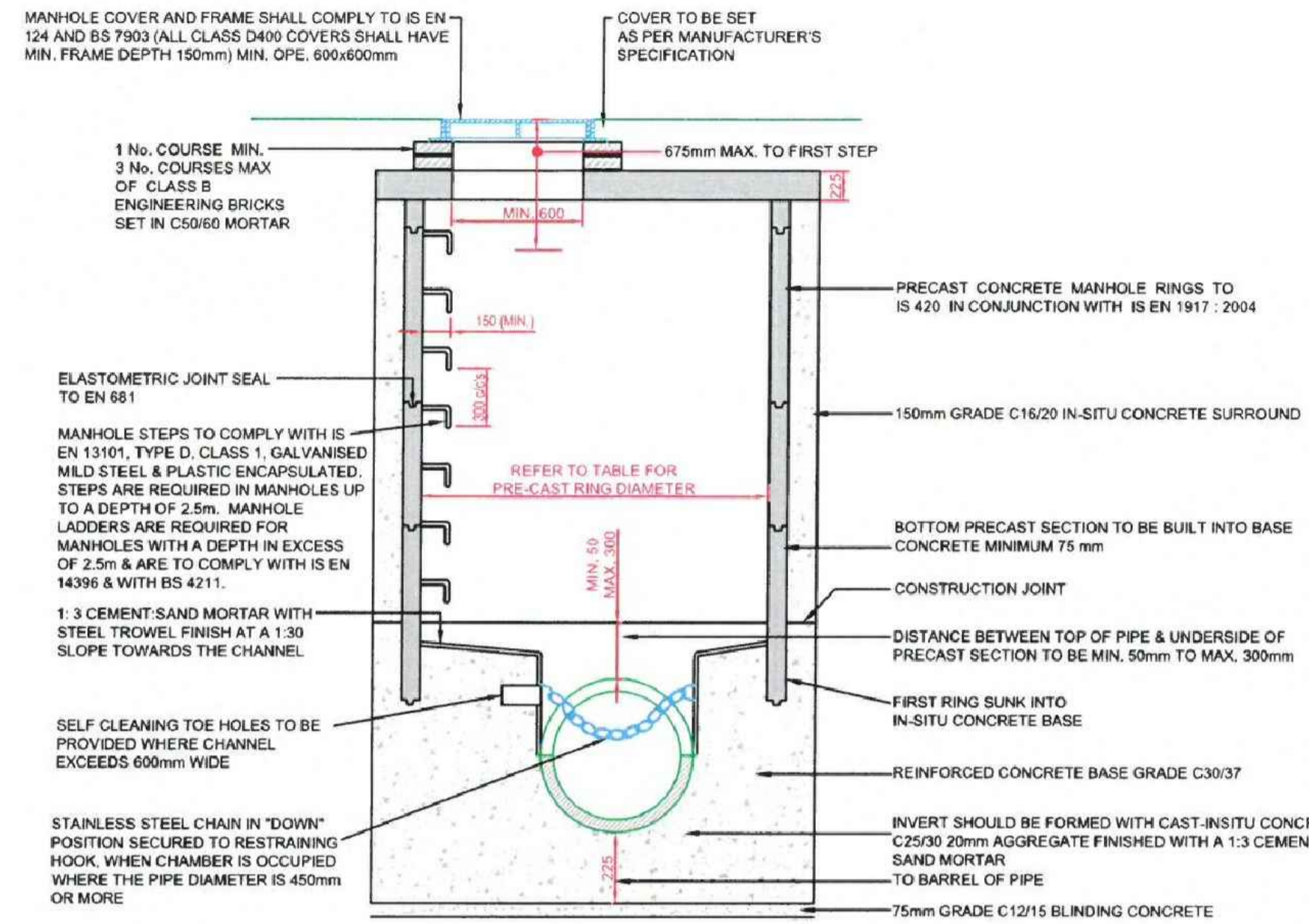

SECTION A-A

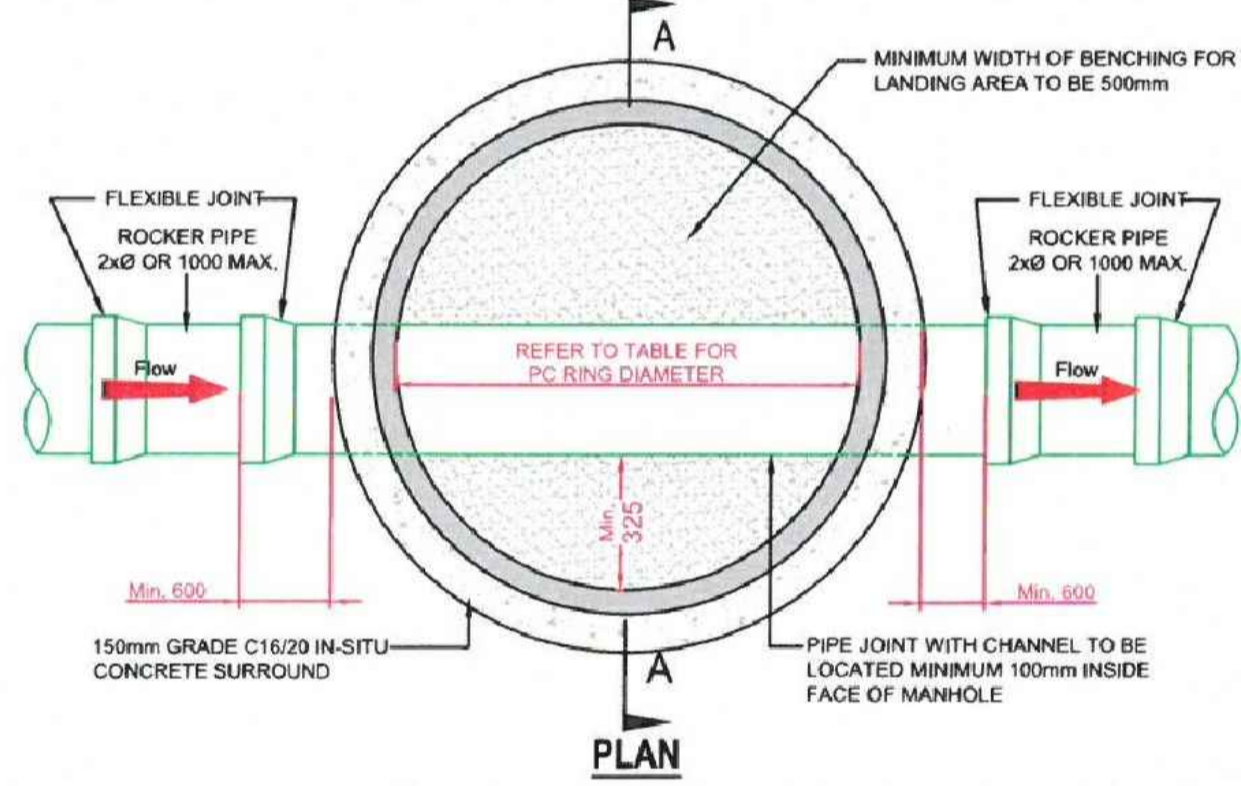

PLAN

MINIMUM MANHOLE DIAMETERS	
DIAMETER OF LARGEST PIPE IN MANHOLE (mm)	INTERNAL DIAMETER OF MANHOLE (mm)
LESS THAN 375	1200
375 TO 450	1350
500 TO 750	1500

TYPICAL MANHOLE DETAILS (scale 1:25)

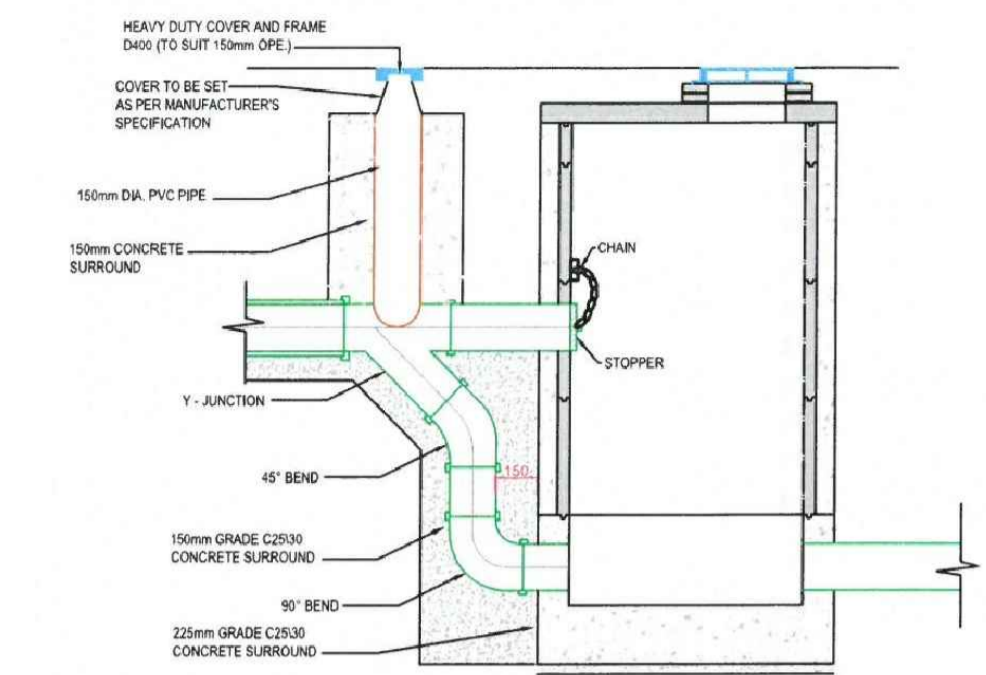

TYPE No. 1

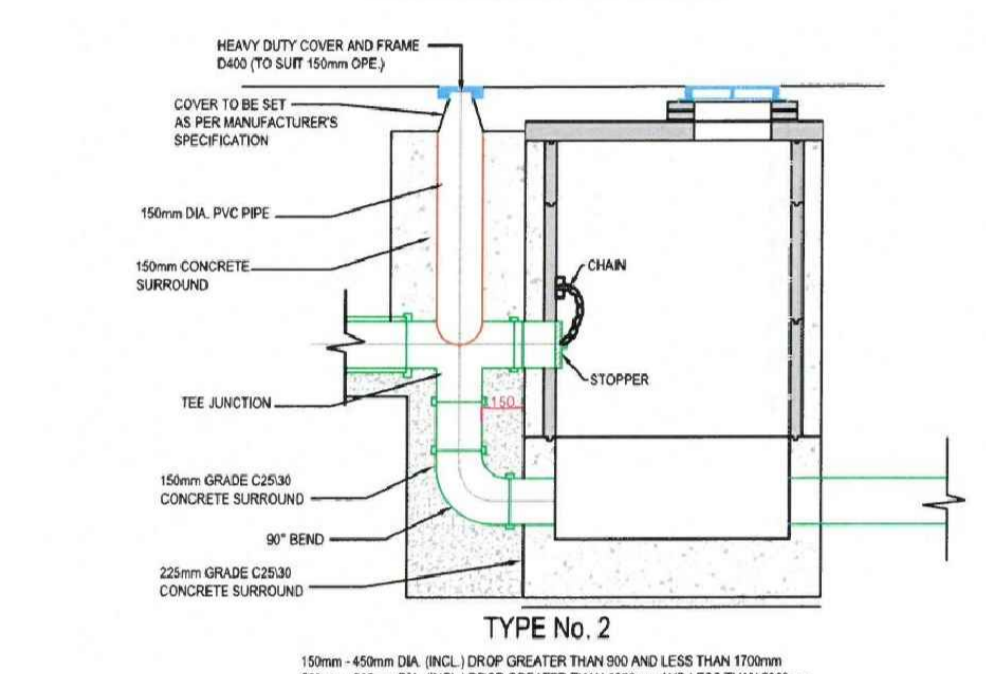

TYPE No. 2

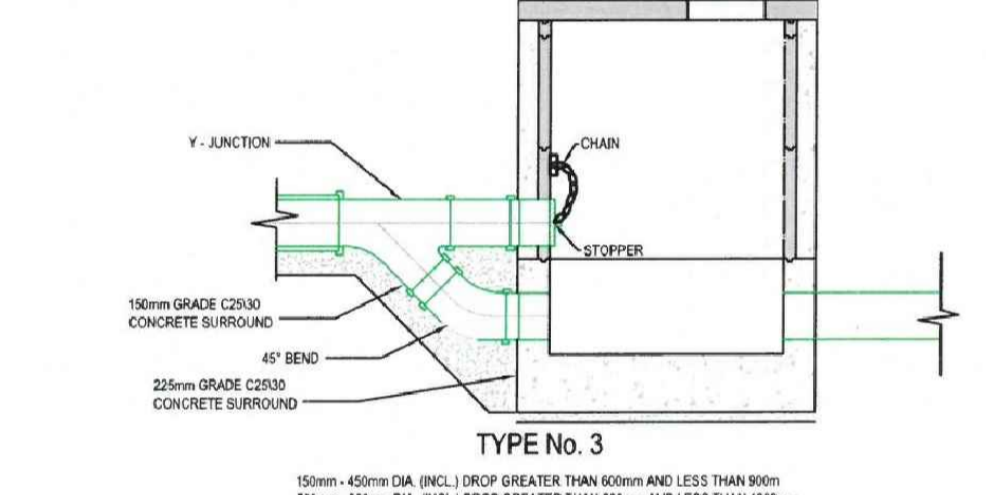

TYPE No. 3

TYPICAL BACKDROP MANHOLE DETAILS (scale 1:25)

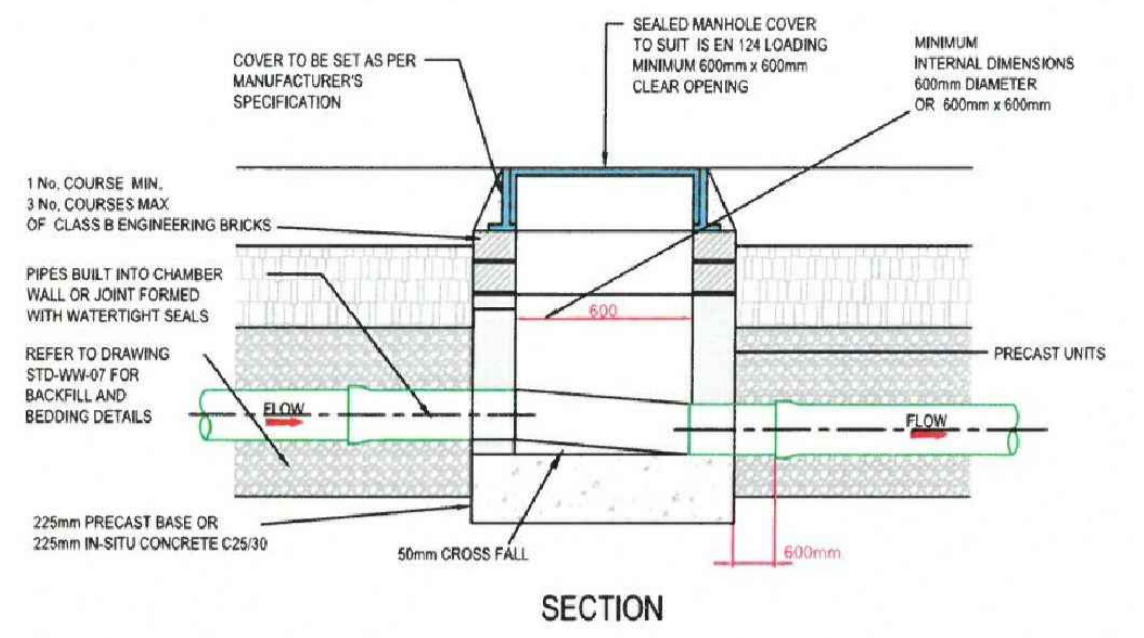

SECTION

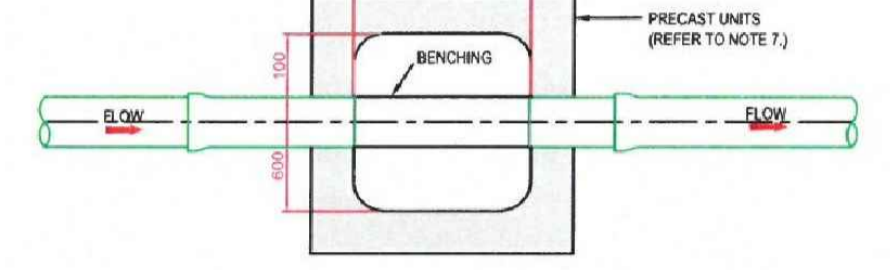

FLOOR PLAN

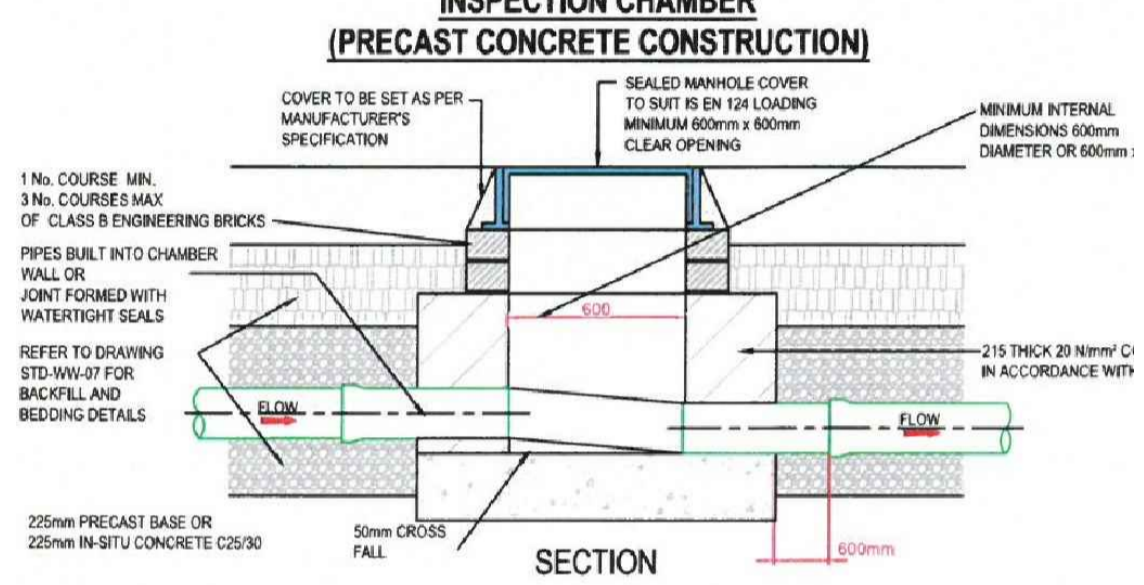

SECTION

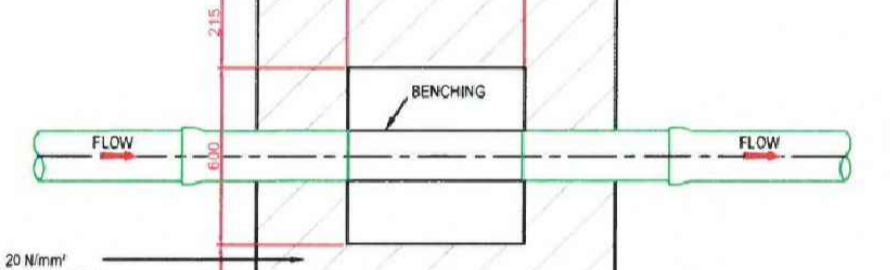

FLOOR PLAN

TYPICAL HOUSE INSPECTION CHAMBER DETAILS (scale 1:25)

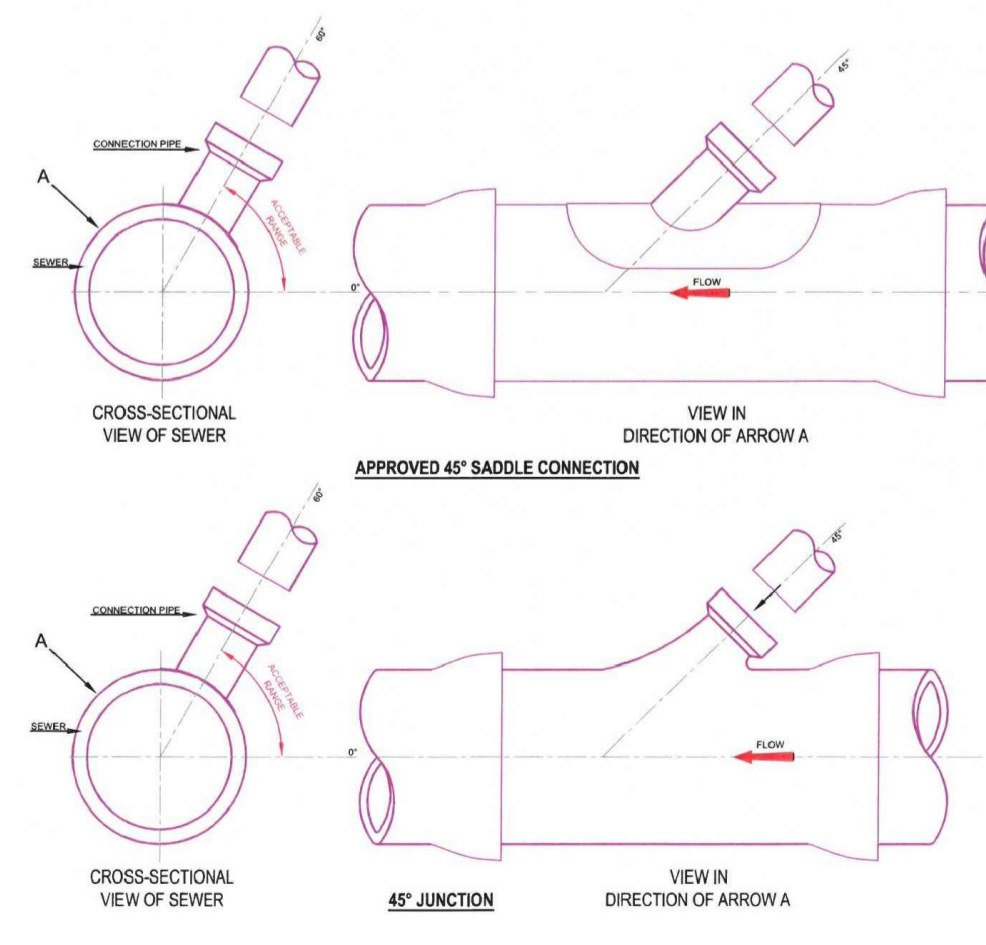

TYPICAL SEWER/SERVICE PIPE CONNECTION (scale 1:10)

**GENERAL NOTES**

The Developer/Contractor/Builder is to ensure that the building under construction/alteration is to comply where applicable with the 2010 Building Regulations in respect of all trades involved in the construction of this development.

The Developer/Contractor/Builder should notify BCA of any intended deviations from these plans prior to commencement of development.

All Site Development works to be carried out in accordance with "Recommendations for Site Development Works for Housing Areas" Dept. of Environment.

Contractors must verify all dimensions at the job before commencing any work. No working dimensions to be scaled. This drawing is for the purpose of planning only. Dimensions to blockwork only.

**Revision**

Date	Rev.

**NOTES:**

ALL WORKS TO COMPLY WITH IRISH WATER CONNECTION AND DEVELOPER SERVICES WASTEWATER INFRASTRUCTURE STANDARD DETAILS

- ALL HOUSE CONNECTIONS IN ACCORDANCE WITH DRG. NO. STD-WW-03
- SEPARATION DISTANCES IN ACCORDANCE WITH DRG. NO. STD-WW-05
- TRENCH BACKFILLING IN ACCORDANCE WITH DRG. NO. STD-WW-07
- MANHOLES CONSTRUCTED IN ACCORDANCE WITH DRG. NO. STD-WW-09 OR 10
- BACKDROP MANHOLES IN ACCORDANCE WITH DRG. NO. STD-WW-12
- ALL PIPES TO BE PVC PIPES AND FITTINGS AND COMPLY WITH THE PROVISIONS OF IS EN 1401:2009/2012. PIPES TO BE APPLICATION AREA CODE "07" STIFFNESS CLASS B/NL. PROVISION FOR JETTING SHALL BE BASED ON THE WIND REMOTE JETTING CODE OF PRACTICE, JUNE 1997. PIPES TO BE CAPABLE OF RESISTING A MAXIMUM JETTING PUMP PRESSURE 2.600psi (180 BARI) WITHOUT DAMAGE.
- PUSH IN RUBBER RING JOINTS SHALL BE PLACED IN ACCORDANCE WITH MANUFACTURERS INSTRUCTIONS FOR THE PIPE MATERIAL.

Client: Westar Investments Ltd.

Job: Clane KDA1 SHD

Location: Lands at Capdoo & Abbeylands, CLane, Co. Kildare

Drawing Title: SERVICES - Foul Sewer Details (SHEET 3 of 3)

**CCO** brian connolly associates CONSULTING ENGINEERS

BSc Eng. MSc, DIC, C.Eng, MIEI  
The Studio, Wood's Way, Clane, Co. Kildare. L 045 892211 L 045 892400  
e: bcassoc@eircom.net

Planning - SHD 02c

job no	18002
date	02.11.18
scale	As Shown @ A1
drawn by	Brian Connolly
cad ref no	300
planning ref no	
fire ref no	
drawing no.	18002-303-16